



SZ-7400-20W

Safety Zone Programmable/Remote Flashing Beacon

SZ SERIES

SELF-CONTAINED 20 WATT SOLAR ENGINE

	Solar Panel Solar Cell - Monocrystalline Silicon Rated Power (Pmp) 20 Watts Rated Voltage (Vmp) 18 VDC Rated Current (Imp) 1.1 Amps CE and TUV certified
	Solar Angle 44° (Standard)
	Standard Battery Bank AGM 12V, 18 Ah - UL Recognized, field replaceable
	Cold Weather Battery Bank Option AGM 12V, 16 Ah - UL Recognized, field replaceable
	Solar Engine Housing Material A5052 Sheet Aluminum (Enclosure) 6061-T6 Aluminum (Mount)
	Solar Engine Dimensions 15.75" x 13.25" X 4.5" (40 x 33.7 x 11.5cm)*

POWER MANAGEMENT

	Rated Usage 300 cycles per day, 25 second activation
	Charged Capacity Up to 30 days at rated usage
	Automatic Light Control (ALC) Various stages of brightness for different solar conditions and battery levels

SYSTEM PROTECTION

	Low Voltage Disconnect 9.5 VDC
	Over Current Protection 1.8 Amp PTC auto-reset fuse
	Self Monitoring Visual notification of sub-optimal operation

LED BEACON SIGNAL HEAD

	Standard Followed ITE VTCOSH-STD 2005
	LED Beacon Signal Head Setup Dual Heads, Vertical Pole Mounting
	Lens Material UV stabilized polycarbonate and Abrasion resistant
	LED Housing 100% Polycarbonate
	LED Size 8" Diameter (200 mm)* 12" Diameter (300mm)*
	LED Housing Dimensions 8" head - 14" x 10" x 6" (35 x 25 x 16 cm)* 12" head - 17" x 14" x 6" (44 x 25 x 17 cm)*
	Std. LED Color Options Amber or Red (custom colors available)

COMMUNICATION

	Band of Operation ISM Band (902-928 MHz)
	Compliance FCC and IC Compliant
	Range Up to 0.5 miles (800 m) with line of sight
	Network Addresses 16 unique addresses to avoid interference between multiple crosswalk locations
	Compatibility Can communicate with other SZ units

SYSTEM OPTIONS

	LED & Solar Engine Housing Colors Yellow, Black or Green (custom colors available)
	
	Mounting Options Side Mount Bracket: 12", and 18" and custom lengths available Signal & Solar Head Side Mount Bracket Custom Mounts Available



7408-20W
44° Standard Angle
8" Amber LEDs



AVAILABLE WITH ANY STANDARD SIGN.
CUSTOM SIGNS ARE AVAILABLE

AVAILABLE WITH RED LEDS FOR STOP
SIGNS, AMBER LEDS FOR WARNING SIGNS



SYSTEM OVERVIEW

Compliance	FHWA MUTCD Compliant
Standard Operation	Programmed Schedule remotely transmitted from Primary SZ units Pedestrian Activated via push button or JSFT remote transmitters
Flash Pattern Options	MUTCD Standard (0.5 seconds ON, 0.5 seconds OFF) JSFT Strobe Energy Efficient Flash Pattern** MUTCD Wig - Wag JSFT Wig - Wag Strobe Energy Efficient Flash Pattern**
Activation Duration	Variable from 5 seconds to 4 hours
Std. Operating Temperature	14°F to +165°F (-10°C to +74°C)
Cold Weather Upgrade Option	-40°F to +176°F (-40°C to +80°C)
System Voltage	12 VDC
Packaged Dimensions	8" head - 36" x 18" x 18" @ 74 lbs (91.5 x 45.7 x 45.7cm @ 34 kg)* 12" head - 36" x 18" x 18" @ 80 lbs (91.5 x 45.7 x 45.7cm @ 36 kg)*

SALES

Toll-Free 1.800.990.2454
sales@jsftech.com

SUPPORT

Toll-Free 1.800.990.2454
support@jsftech.com

ADDRESS

6582 Bryn Road,
Victoria, BC V8M 1X6

WARRANTY 5-year Limited Warranty for defects in workmanship and materials (excludes batteries and vandalism)

SZ-7400-20W
Safety Zone Programmable/Remote Flashing Beacon

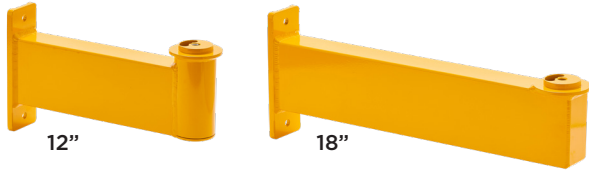

SIDE MOUNT BRACKET



SIGNAL HEAD & SOLAR ENGINE
SIDE MOUNT BRACKET

SIGNAL HEAD MOUNTING OPTIONS

SOLAR ENGINE MOUNTING OPTIONS

ISO VIEW

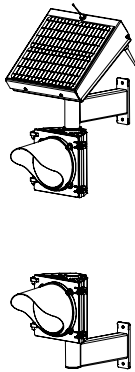

SZ-7408-20W

FRONT VIEW

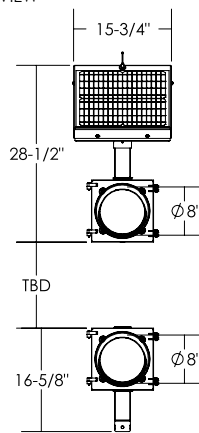

SIDE VIEW

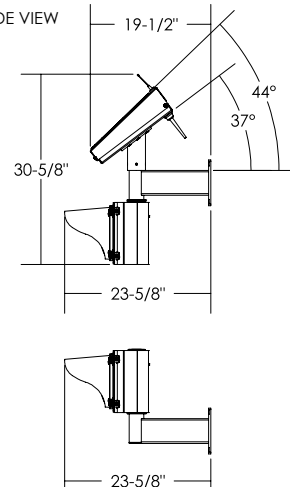

ISO VIEW

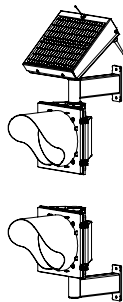

SZ-7412-20W

FRONT VIEW

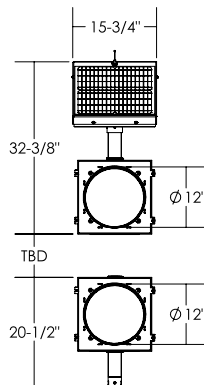

SIDE VIEW

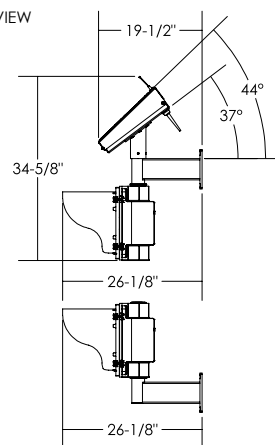

SYSTEM DRAWINGS



SZ-7400-40W

Safety Zone Programmable/Remote Flashing Beacon



SELF-CONTAINED 40 WATT SOLAR ENGINE

	Solar Panel Solar Cell - Monocrystalline Silicon Rated Power (Pmp) 40 Watts Rated Voltage (Vmp) 18 VDC Rated Current (Imp) 2.2 A Certifications: CE and TUV certified
	Solar Angle 44° (Standard)
	Standard Battery Bank 2 x AGM 12V, 18 Ah - UL Recognized, field replaceable
	Cold Weather Battery Bank Option 2 x AGM 12V, 16 Ah - UL Recognized, field replaceable
	Solar Engine Housing Material A5052 Sheet Aluminum (Enclosure) 6061-T6 Aluminum (Mount)
	Solar Engine Dimensions 30.875" x 13.25" x 4.5" (78.4 x 33.7 x 11.5cm)*

POWER MANAGEMENT

Rated Usage	300 cycles per day, 25 second activation
Charged Capacity	Up to 30 days at rated usage
Automatic Light Control (ALC)	Various stages of brightness for different solar conditions and battery levels

SYSTEM PROTECTION

Low Voltage Disconnect	9.5 VDC
Over Current Protection	1.8 Amp PTC auto-reset fuse
Self Monitoring	Visual notification of sub-optimal operation

LED BEACON SIGNAL HEAD

Standard Followed	ITE VTCOSH-STD 2005
LED Beacon Signal Head Setup	Dual Heads, Vertical Pole Mounting
Lens Material	UV stabilized polycarbonate and Abrasion resistant
LED Housing	100% Polycarbonate
LED Size	8" Diameter (200 mm)* 12" Diameter (300mm)*
LED Housing Dimensions	8" head - 14" x 10" x 6" (35 x 25 x 16 cm)* 12" head - 17" x 14" x 6" (44 x 25 x 17 cm)*
Std. LED Color Options	Amber or Red (custom colors available)

COMMUNICATION

Band of Operation	ISM Band (902-928 MHz)
Compliance	FCC and IC Compliant
Range	Up to 0.5 miles (800 m) with line of sight
Network Addresses	16 unique addresses to avoid interference between multiple crosswalk locations
Compatibility	Can communicate with other SZ units

SYSTEM OPTIONS

LED & Solar Engine Housing Colors	Yellow, Black or Green (custom colors available) 
Mounting Options	Side Mount Bracket: 12", and 18" and custom lengths available Signal & Solar Head Side Mount Bracket Custom Mounts Available



7408-40W
44° Standard Angle
8" Amber LEDs



AVAILABLE WITH ANY STANDARD SIGN.
CUSTOM SIGNS ARE AVAILABLE



AVAILABLE WITH RED LEDS FOR STOP SIGNS,
AMBER LEDS FOR WARNING SIGNS

SYSTEM OVERVIEW

Compliance	FHWA MUTCD Compliant
Standard Operation	Programmed Schedule remotely transmitted from Primary SZ units Pedestrian Activated via push button or JSFT remote transmitters
Flash Pattern Options	MUTCD Standard (0.5 seconds ON, 0.5 seconds OFF) JSFT Strobe Energy Efficient Flash Pattern** MUTCD Wig - Wag JSFT Wig - Wag Strobe Energy Efficient Flash Pattern**
Activation Duration	Variable from 5 seconds to 4 hours
Std. Operating Temperature	14°F to +165°F (-10°C to +74°C)
Cold Weather Upgrade Option	-40°F to +176°F (-40°C to +80°C)
System Voltage	12 VDC
Packaged Dimensions	8" head - 36" x 18" x 18" @ 74 lbs (91.5 x 45.7 x 45.7cm @ 34 kg)* 12" head - 36" x 18" x 18" @ 80 lbs (91.5 x 45.7 x 45.7cm @ 36 kg)*

SALES
Toll-Free 1.800.990.2454
sales@jsftech.com

SUPPORT
Toll-Free 1.800.990.2454
support@jsftech.com

ADDRESS
6582 Bryn Road,
Victoria, BC V8M 1X6

WARRANTY 5-year Limited Warranty for defects in workmanship and materials (excludes batteries and vandalism)

SZ-7400-40W
Safety Zone Programmable/Remote Flashing Beacon

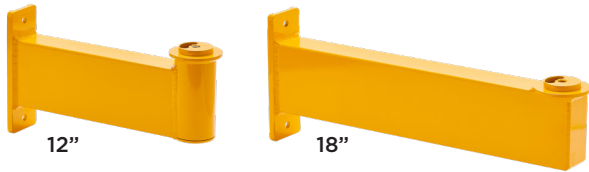

SIDE MOUNT BRACKET



SIGNAL HEAD & SOLAR ENGINE
SIDE MOUNT BRACKET

SIGNAL HEAD MOUNTING OPTIONS

SOLAR ENGINE MOUNTING OPTIONS

ISO VIEW

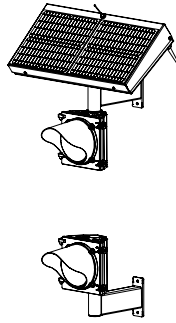

SZ-7408-40W

FRONT VIEW

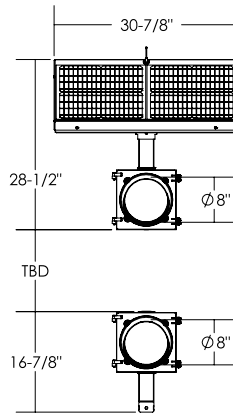

SIDE VIEW

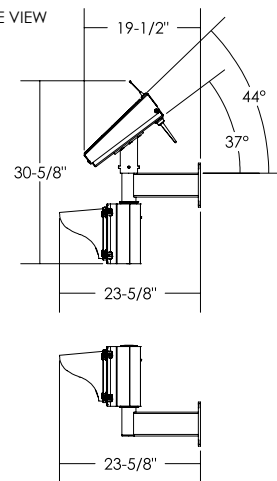

ISO VIEW

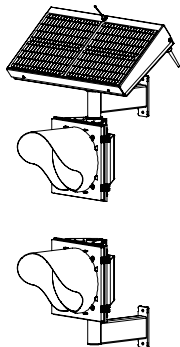

SZ-7412-40W

FRONT VIEW

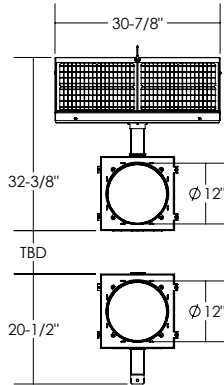

SIDE VIEW

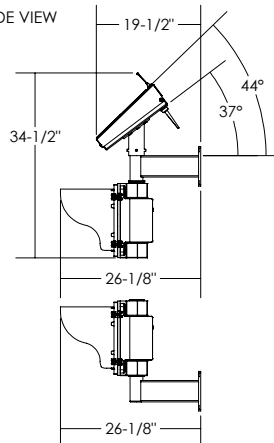

SYSTEM DRAWINGS

SZ-7400-AC

Safety Zone Programmable/Remote Flashing Beacon



AC ENCLOSURE

Enclosure Material	0.08" Type 5052 H-32 aluminum
Enclosure Dimensions (Small)	12" x 12" x 4" (30 x 30 x 10cm)*
Enclosure Dimensions (Large)	16" x 14" x 8" (41 x 36 x 20cm)*
Standards	UL 508 Type 3R, 4, 4X, 12, and 13 CSA Type 3R, 4, 4X, 12, and 13
Compliance	NEMA Type 3R, 4, 4X, 12 and 13 JIC EGP-1-1967 IEC 60529, IP66
Enclosure Colors	Aluminum, Black, Green or Yellow (Custom Colors Available)



AC BRICK SPECIFICATIONS

Dimensions	6.375" x 1.625" x 1.25" @ 0.9 lbs (16.25 x 4.3 x 3.2 cm @ 0.41 kg)*
Power Supply Rating	120 VAC to 15 VDC Class 2 Supply
Standards	IP67, CE Certified, UL Recognized

SYSTEM PROTECTION

Over Current Protection	1.8 Amp PTC auto-reset fuse
Self Monitoring	Visual notification of sub-optimal operation

LED BEACON SIGNAL HEAD

Standard Followed	ITE VTCOSH-STD 2005
LED Beacon Signal Head Setup	Dual Heads, Vertical Pole Mounting
Lens Material	UV stabilized polycarbonate and Abrasion resistant
LED Housing	100% Polycarbonate
LED Size	8" Diameter (200 mm)* 12" Diameter (300mm)*
LED Housing Dimensions	8" head - 14" x 10" x 6" (35 x 25 x 16 cm)* 12" head - 17" x 14" x 6" (44 x 25 x 17 cm)*
Std. LED Color Options	Amber or Red (custom colors available)

COMMUNICATION

Band of Operation	ISM Band (902-928 MHz)
Compliance	FCC and IC Compliant
Range	Up to 0.5 miles (800 m) with line of sight
Network Addresses	16 unique addresses to avoid interference between multiple crosswalk locations
Compatibility	Can communicate with other SZ units

SYSTEM OPTIONS

LED Housing Colors	Yellow, Black or Green (custom colors available)
--------------------	---



Mounting Options	Side Mount Bracket: 12", and 18" and custom lengths available Custom Mounts Available
------------------	---



7408-AC
8" Amber LEDs

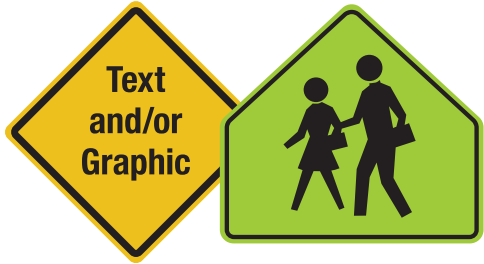

AVAILABLE WITH ANY STANDARD SIGN.
CUSTOM SIGNS ARE AVAILABLE

AVAILABLE WITH RED LEDES FOR STOP
SIGNS, AMBER LEDES FOR WARNING SIGNS

SYSTEM OVERVIEW

Compliance	FHWA MUTCD Compliant
Standard Operation	Programmed Schedule remotely transmitted from Primary SZ units Pedestrian Activated via push button or JSFT remote transmitters
Flash Pattern Options	MUTCD Standard (0.5 seconds ON, 0.5 seconds OFF) JSFT Strobe Energy Efficient Flash Pattern** MUTCD Wig - Wag JSFT Wig - Wag Strobe Energy Efficient Flash Pattern**
Activation Duration	Variable from 5 seconds to 4 hours
Std. Operating Temperature	-40°F to +176°F (-40°C to +80°C)
System Voltage	12 VDC
Packaged Dimensions	Varies depending on configuration and installation method

SALES
Toll-Free 1.800.990.2454
sales@jsftech.com

SUPPORT
Toll-Free 1.800.990.2454
support@jsftech.com

ADDRESS
6582 Bryn Road,
Victoria, BC V8M 1X6

WARRANTY 5-year Limited Warranty for defects in workmanship and materials (excludes batteries and vandalism)

*All measurements and weights are approximate **50% power consumption of MUTCD



SZ-7400-AC
Safety Zone Programmable/Remote Flashing Beacon

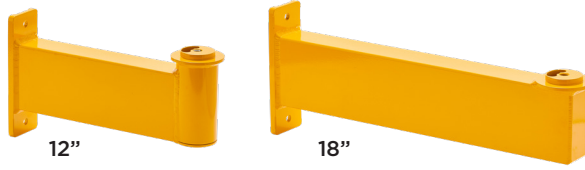

SIDE MOUNT BRACKET

SIGNAL HEAD MOUNTING OPTIONS

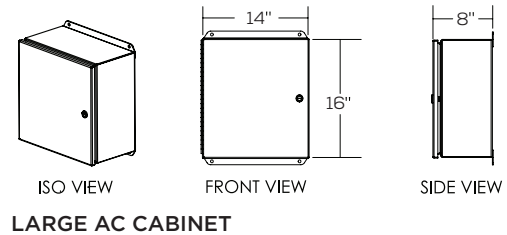
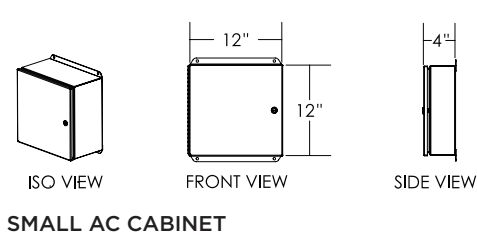
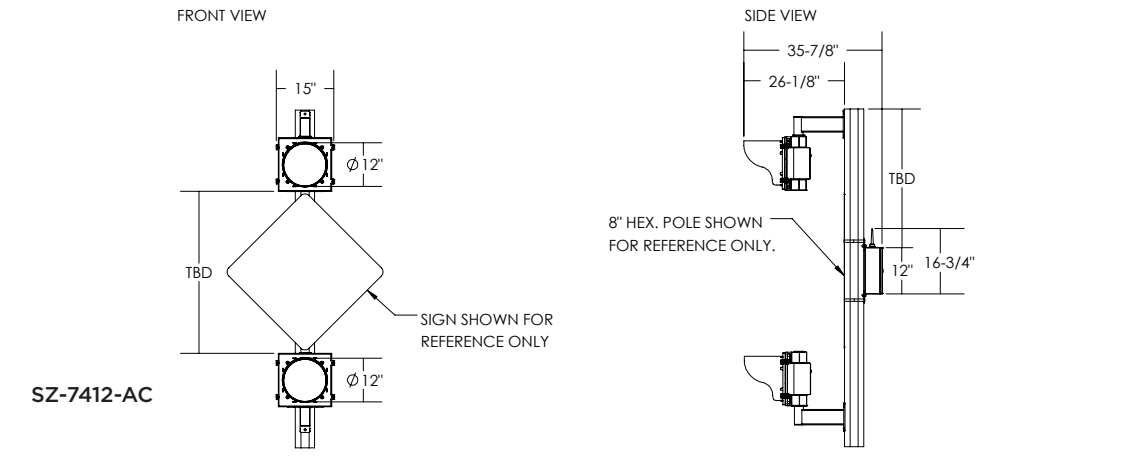
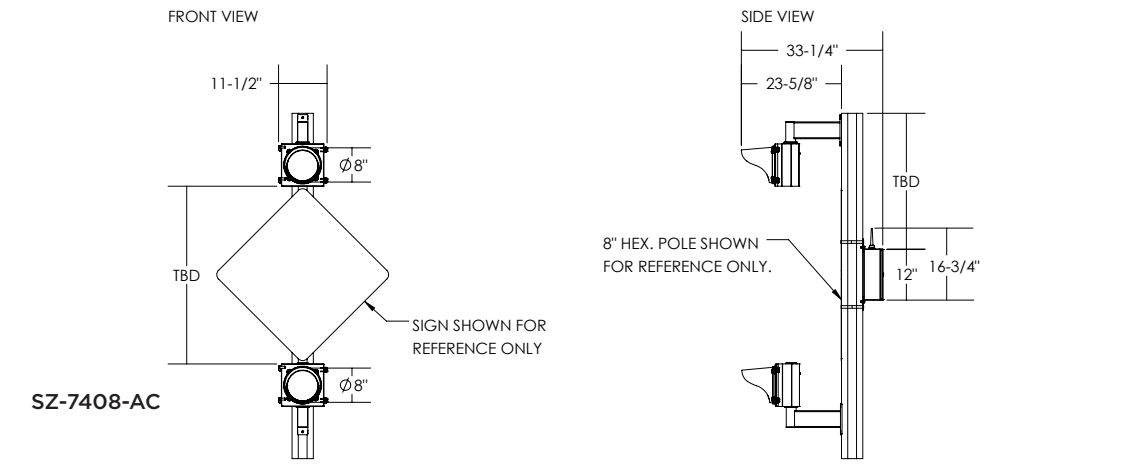

SYSTEM DRAWINGS